

PART# E50019		ECN	NAME
REV	DESCRIPTION	DATE	
-	-	-	-

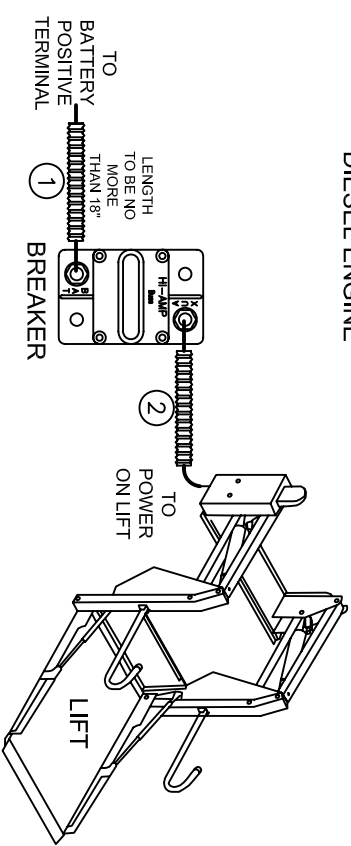

CIRCUIT ITEMS	ITEM #	QTY	WIRE SIZE/COLOR	CALC. AMP	ACTUAL AMP
HARNES TO BATTERY POWER	1	1	4 GA. RED	-	-
HARNES TO POWER LIFT	2	1	4 GA. RED	-	-
-	-	-	-	-	-
-	-	-	-	-	-
-	-	1	-	-	-

NOTE: HARNES RUNS DOWN FENDER UNDER PASSENGER STEP TO FRAME AND UP TO LIFT

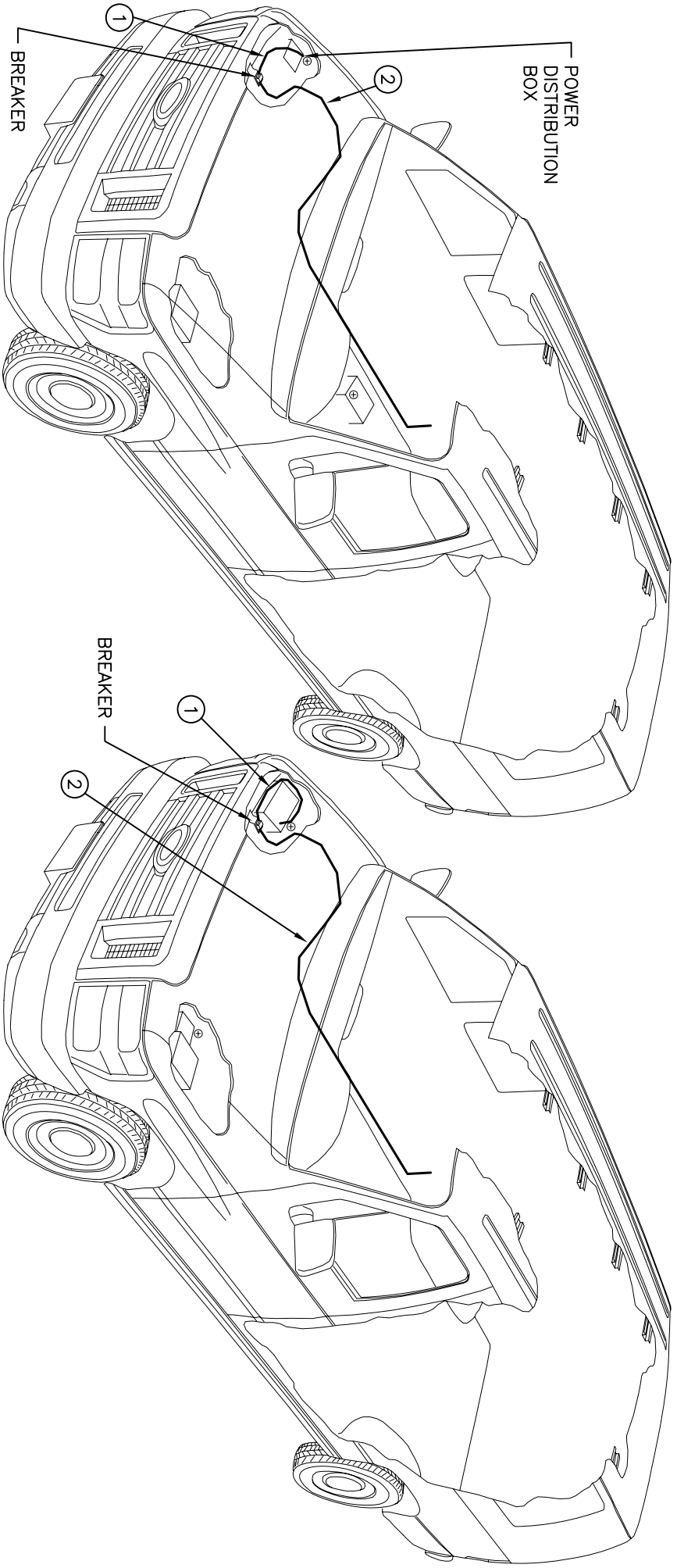

THIS PRINT IS LOANED ON A CONFIDENTIAL BASIS. SUBJECT TO RETURN UPON DEMAND BY ACCUBUILT AND NOTHING HEREIN MAY BE REPRODUCED, USED OR DISCLOSED IN WHOLE OR IN PART WITHOUT THE PRIOR WRITTEN PERMISSION OF ACCUBUILT.

TOLEANCE UNLESS NOTED  
 1 PLACE: ± 0.1  
 2 PLACE: ± 0.06  
 3 PLACE: ± 0.031  
 ANGLES: ± 1.0°  
 DO NOT SCALE DRAWING. ALL DIMENSIONS ARE AS SHOWN UNLESS OTHERWISE NOTED.

SCALE: NTS  
 DRAWN BY: SDG  
 DATE: 12/3/08  
 CHECKED: -

CHASSIS: FORD COMMERCIAL E150 & E250  
 MODEL YEAR: 2009  
 TITLE: BRAUN/RICON SIDE LIFT POWER LAYOUT - DIESEL AND GAS  
 PART NO.: E50019  
 REF: -  
 SHEET SIZE: A  
 SHT NO.: -