

PART# E50017		ECN	NAME
REV	DESCRIPTION	DATE	
-	-	-	-

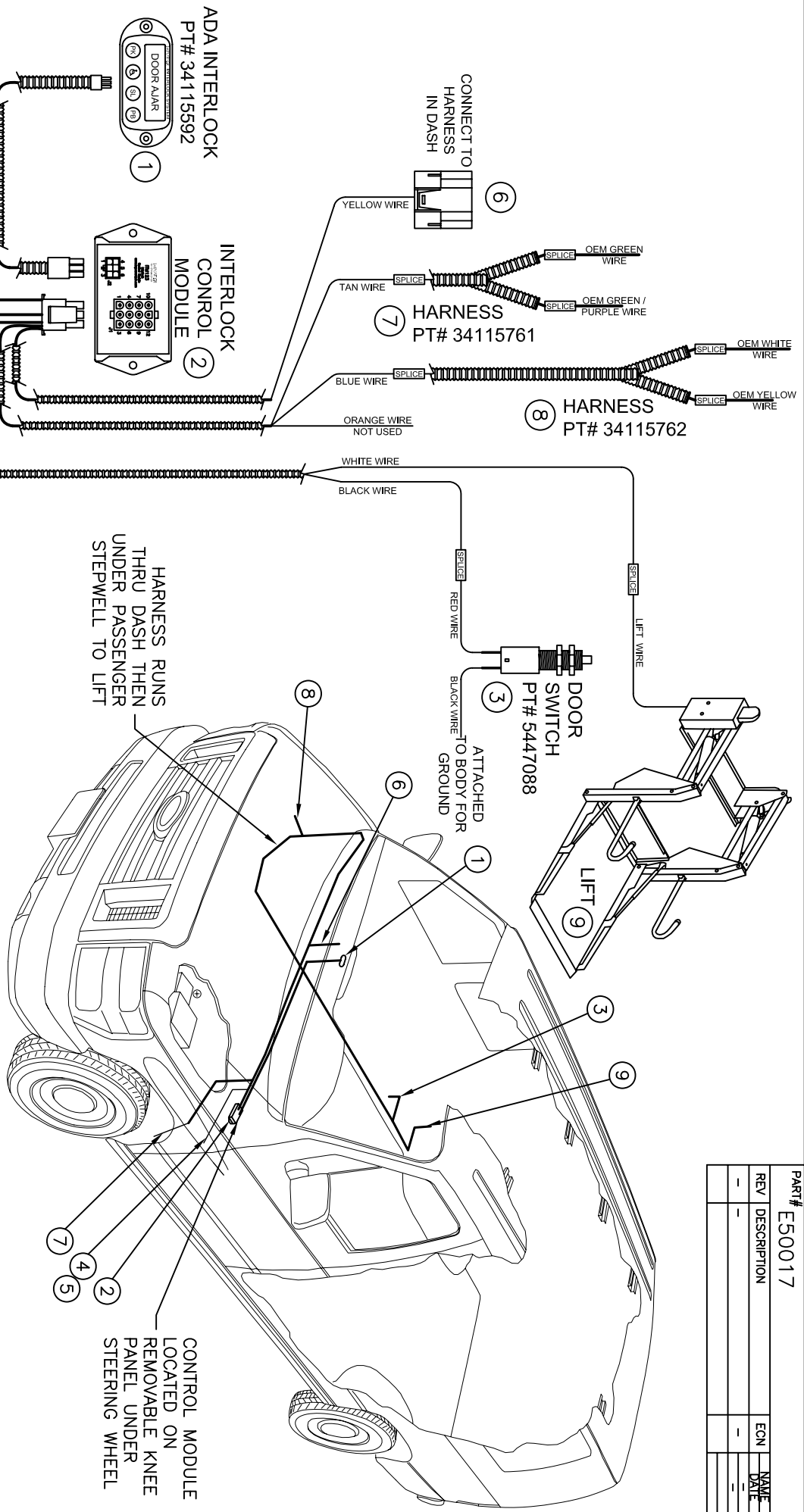

**DISPLAY KEY:**

- PK = PARKING BREAK HAS BEEN ENGAGED
- ⊕ = LIFT HAS BEEN ENABLED
- SL = SHIFT LOCK HAS BEEN ENGAGED
- PB = PARKING BRAKE HAS BEEN SET

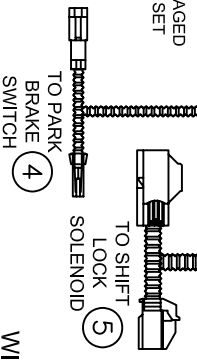

WITH DIESEL USE  
FAST IDLE SYSTEM

CIRCUIT ITEMS	ITEM #	QTY	WIRE SIZE/COLOR	CALC. AMP	ACTUAL AMP
ADA INTERLOCK DISPLAY	1	1	VARIOUS/CONNECTOR	<1.0	-
INTERLOCK CONTROL MODULE	2	1	VARIOUS/2 CONNECTORS	<1.0	-
DOOR PIN SWITCH	3	1	BLACK WIRE	<1.0	-
PARK BRAKE SWITCH HARNESS	4	1	VARIOUS/CONNECTOR	<1.0	-
TRANSMISSION IN PARK SIGNAL	5	1	VARIOUS/CONNECTOR	<1.0	-
12 VOLT POWER	6	1	CONNECTOR	<1.0	-
HARNESS WITH DIODE 34115761	7	1	TAN WIRE	<1.0	-
HARNESS WITH DIODE 34115762	8	1	BLUE WIRE	<1.0	-
LIFT CIRCUIT POWER	9	1	WHITE WIRE	<1.0	-



THIS PRINT IS LOANED ON A CONFIDENTIAL BASIS SUBJECT TO RETURN UPON DEMAND BY ACCUBUILT AND NOTHING HEREIN MAY BE REPRODUCED, USED OR DISCLOSED IN WHOLE OR IN PART WITHOUT THE PRIOR WRITTEN PERMISSION OF ACCUBUILT.

TOLERANCE UNLESS NOTED  
1 PLACE: ± 0.1  
2 PLACE: ± 0.06  
3 PLACE: ± 0.031  
ANGLES: ± 1.0°

SCALE  
NTS  
DRAWN BY SDG  
CHECKED -  
DATE 1/9/09

CHASSIS  
TITLE  
FORD COMMERCIAL E-SERIES  
BRAUN/RICON SIDE LIFT W/ADA INTERLOCK ELECTRICAL LAYOUT  
PART NO. E50017  
REF: -  
SHEET SIZE A  
SHT NO. -  
MODEL YEAR 2009